



# SERIES 'DP' DRUM PUMP

## OPEN DRIP PROOF AND TOTALLY ENCLOSED MOTORS FOR DRUM PUMPS

**WARNING: Motor should not be used to pump flammables.**

ODP-S		ENC-S	
52-8000	115V	52-3000	115V
52-8001	230V	52-3001	230V

Refer to Bulletin P-402, Operation and Service Guide O-176 and Master Price List F-800.

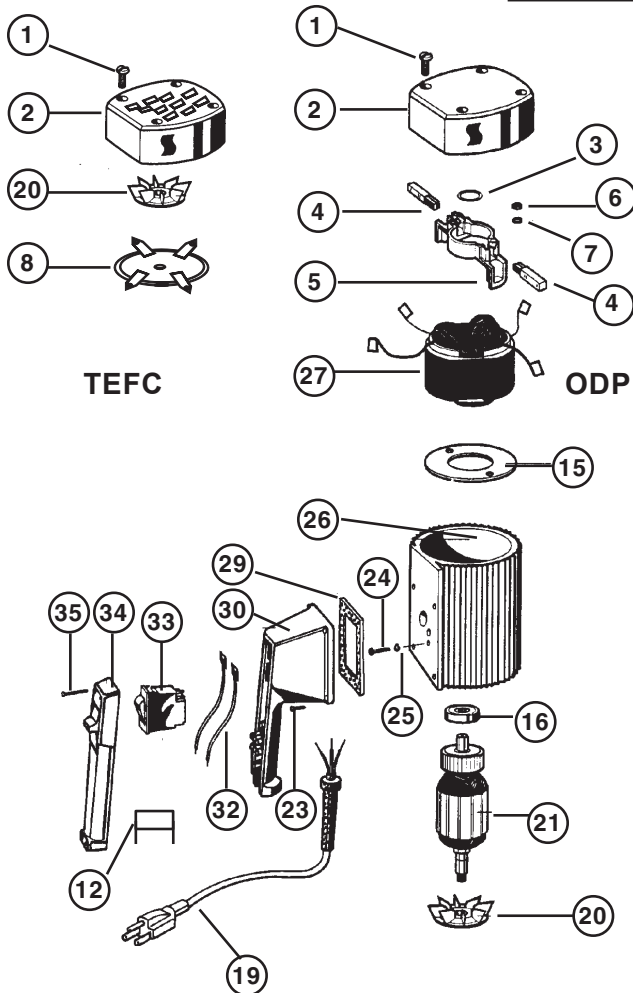

TEFC

ODP

ITEM	DESCRIPTION	PART NUMBER	
		ODP	ENC
1	Screw (8 req'd)	52-8130 1	52-3130
2	Motor cover	52-8123	52-3123
3	Wave washer	52-8125	
4	Carbon brush (2 req'd) - 115V - 230V	52-8509	52-8703
5	Brush holder	52-8508	
6	Hexagon nut (2 req'd)	52-8448	
7	Lockwasher (2 req'd)	52-8071	
8	End shield	-	52-3511
9	Pressure spring (2 req'd)	52-8507	-
10	Rod connector (2 req'd)	52-8506	52-3703
11	Ball bearing, sealed	52-8126	
12	Capacitor 230V only	52-8184	
13	Lower housing	52-8100	
14	Motor coupling	52-8333	
15	Guide disc	52-8504	52-3504
16	Ball bearing, sealed	52-8331	
19	Power cord w/strain relief - 115V - 230V	52-8360	52-8705
20	Fan	52-8501	52-3501
21	Armature - 115V - 230V	52-8502 52-8701	52-3502 52-3701
23	Screw (4 req'd)	52-8131	
24	Screw	52-8162	
25	Lock washer	52-8071	
26	Motor housing - 115V - 230V	52-8510	52-3510 52-3510 2
27	Stator - 115V - 230V	52-8503 52-8702	52-3503 52-3702
29	Gasket Gasket for switch w/Low Volt. Release	52-8167 52-8167 L	
30	Switch housing (includes Potentiometer) -115V -220V	52-8004 52-8005	
32	Lead	52-8185	
33	Switch - 115V - 230V Switch w/Low Voltage Release - 230V	52-8611 52-8704 52-8704 L	
34	Switch cover	52-8002	
35	Screw (5 req'd)	52-8220	
36**	Speed control, Potentiometer ass'y - 115V - 230V	52-9800 H 52-9801 H	
37	Motor housing sleeve for 230V TEFC only	-	52-3503 1NS

**\*\* ⚠ WARNING**

The speed control switch should not be used as the main on/off switch. Using the speed control switch in this manner causes excessive wear to the speed control and may result in premature failure. The use of the speed control switch does not cut power to the motor and inadvertent activation could result in injury or death if the motor is activated when not properly attended and secured.